



Ninilchik Senior Center

PO Box 39422. 66265 Aspen Ave. Ninilchik, AK. 99639 Phone: 567-3988

Coming Up:

Time Change 10th

**Special Membership
Meeting 11th**

AARP Tax Day 12th

**St. Patrick's Day
17th**

Spring Begins 19th

Board Meeting 19th

Easter 31st



Note From the President of the Board:

Welcome to March everyone. We made it through February, which was extra-long on this year. The membership meeting scheduled for March 11 is fast approaching. The meeting is right after lunch, 12:45 pm. We need you to attend so you can have your voice in this process. We will be voting on an amendment to the by-laws. If you are a member of the Senior Center and are in town I hope to see you there.

March always brings St. Patrick's Day. The wearing of the green. Everybody gets to be Irish for a day. There would be some fun decorations and a great meal on that day except that March 17 falls on a Sunday this year so, our traditional corned beef and cabbage meal will be on Friday the 15th instead.

Daylight savings time starts on March 10 this year. Remember to set your clocks forward one hour. This if you still a timepiece that doesn't do that automatically. Has anyone ever stayed up until 2:00 am to watch their phone update itself? Don't set up an appointment for 2:30 am on the tenth! If you think about it, there is no such time on March 10th. Am I thinking about this too much?

Easter comes along on March 31 this year. Christ is risen, He is risen indeed. That is also the end of the lenten season. If you gave anything up for lent you just have to make it through March and you will have been successful. As for me, I gave up cookies this year. Pray for me.

Our Gun show is scheduled for May 18th and 19th. The planning is well underway for this event. There will be between 30 and 40 vendors at this event. Guns, knives, and ammo. There will also be a gun raffle. Put it on your calendar. It will be an exciting and fun event.

Finally, have you noticed the daylight lately? Days are getting longer fast these days. I have always loved watching the sun come up earlier and set later. It is fun watching the sun move its way north along the mountains across the inlet. Happy spring everybody!!!!

~ Richard Hawkins

A Note from the Executive Director:

Aaaahhhh March! The month that spring begins, or at least that's what the calendar says! Alaska's weather does not always agree that it's spring in March, but regardless of the amount of snow left each year at this time, we can still see the signs of spring.....especially with the amount of daylight. This month we gain more than two hours! Summer will soon follow and we'll once again be able to go outside without worrying about ice and snow!

March is a busy month! Time change on March 10th, membership meeting right after lunch on March 11th, AARP here to do taxes for those 60 and over on March 12, traditional St. Patrick's day meal on March 15th, spring begins on March 19th, and last but not least, Easter and the last day to file your PFD's on March 31st. If you need more info or assistance with any of these events or activities, feel free to call the center or stop by the office.

Be sure to check out our menu for this month, lots of great meals being served Monday through Friday. Join us when you can, lunch is served at noon. Bring your friends, the more the merrier! Our kitchen staff is the best in the land (and yes I'm a little biased!). They work hard every day preparing nutritious and delicious lunches for all of us. Remember to give them a thumbs up or a thank you once in a while. They do a great job, and really do seem to enjoy preparing the meals as much as we enjoy eating them! Thank you MarteSue, Casey and Rick! Just a quick reminder that we are still raising money for our kitchen expansion. Our kitchen size has been the same since 1983; we need more space! Let me know if you have ideas on how we can get to our goal and get these expansion plans completed! Thank you to all of you who have already contributed, it is so very much appreciated!

~ Julie Otto





WOW, looks like March is coming in like a lion so let's hope it goes out like a lamb. After all the last day of March is Easter Sunday! March is a happening month with Baseball Spring Training at full force, NCAA March Madness Men and Women's Basketball, (how about that Caitlyn Clark #22 from Iowa!!) St. Patrick's Day, Spring arrives, Daylight Savings Time, Women's History Month, and Easter. Full month I'd say. Thank you to those that texted me saying they liked the monthly Trivia so guess what?! Here comes March Trivia!!

1. What is the 15th day of March known as in the Roman Calendar?
2. What is the flower for March?
3. Spring falls on one of these three dates in March every year, what are they?
4. What do animals start waking up from in March? (no not a hangover)
5. What college basketball event happens in March?
6. What do Math enthusiasts celebrate on March 16?
7. What day does Daylight Saving Time fall on?
8. What happens during Daylight Savings time? (for the states that have it)
9. How many days in March? I know you all counted on your knuckles didn't you!!
10. What other month finishes on the same day of the week as March every year?
11. What month in the Southern Hemisphere is the equivalent to March?
12. What 2 teams played in the first Men's NCAA Championship Game in March Madness?

- 13..Bonus question Who Won?
- 14.What NCAA Men's basketball team has won the most National Championships?
- 15.What woman was the first female Secretary of State?
- 16.What female poet wrote "When the Caged Bird Sings"?
- 17.When was the 1st Women's History Day Celebrated?
- 18.What U.S. Territory was the 1st in the country to give Women the Right to Vote?
- 19.Who was the 1st Woman in the U.S. to earn a Medical Degree?
- 20.What was the 1st year Women were allowed to obtain credit cards?
- 21.Who was the 1st Woman to be awarded the Nobel Peace Prize?
- 22.Who was the 1st Black Female millionaire in the U.S.?
- 23.What country was St. Patrick born in?
- 24.What was the original color associated with St. Patrick's Day?
- 25.What are the odds of finding a 4-leaf clover?
- 26.How many pints of Guinness are bought each year on St. Patrick's Day



Answers:

- | | |
|---------------------------------------|---|
| 1. 1.The Ides of March | 16.February 28, 1909 |
| 2. Daffodil | 15.Wyoming Territory |
| 3. 19th, 20th, 21st | 18.Elizabeth Blackwell |
| 4. Hibernation | 19. 1974 |
| 5. March Madness | 20.Jane Adams |
| 6. PI Day | 21. Madam C. Walker |
| 7. Second Sunday in March | 22.Britain |
| 8. Clocks move forward 1 hour | 23. Azure Blue |
| 9. 31 | 24.1 in 10,000 |
| 10. June | 25. 13 million pints |
| 11. September | May the Leprechaun find you and give you good luck! |
| 12.Ohio State and University of Orego | Remember to Swing for the fence! ~Cheryl |
| 13.UCLA | |
| 14.Madeline Albright | |
| 15.Maya Angelou | |

Ninilchik Senior Citizens, Inc

Presents Our

Special Membership Meeting

Monday, March 11, 2024

at 12:45 pm



Reminder:

**To vote on any item at this meeting,
your Membership Dues must be
current**

ST. PATRICK'S DAY CROSSWORD PUZZLE



Across

4. capital of Ireland
5. a type of Irish dance
7. if you do not wear green on March 17 this will happen
9. the day St. Patrick's Day falls on
11. the national emblem of Ireland
12. yellow and blue make _____
13. from Ireland

Down

1. the 3rd month of the year
2. good fortune
3. nonsense or misleading talk
6. called the Emerald Isle
7. a starchy vegetable
8. a sprite
10. 4 leaf _____



1985 Teddy's Toys & Co., All Rights Reserved.

All Questions and answers are from 1985 Teddy's Toys & Co., All Rights Reserved.

1. 95% of all Alaskans do not indulge in what public recreation?
2. What is the coldest month in the southeast region?
3. In the fishing industry, what is a “packer”?
4. Name the clam with a neck that can stretch from three to five feet?>
5. Name the place in Northern Alaska that was originally named Moses Village.
(Artic Village, Tanana, Glenallen)
6. What was the highest amount of rainfall ever recorded in Alaska?
(180 inches, 227 inches, 332 inches)
7. True or False, Over \$1,000,000 was found on the beaches on Nome in the form of Gold.
8. What is the highest recorded temperature in the state?
(95 F, 98 F, 100 F)

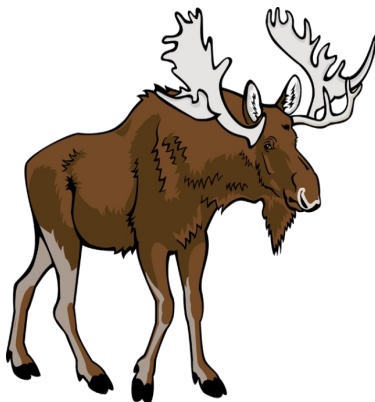

1. Use of Forest Service cabins accessible by plane or boat.
2. January
3. A large boat that pays cash for the fish from the fisherman while on the fishing grounds
4. Geo Duck
5. Artic Village
6. 332 inches in 1976 in the Gulf of Alaska
7. True
8. 100 F

Please see the office to sign up for computer lessons!

Including:

- Basic computer navigation skills
- How to search the internet
- Video Chat with family
- Internet Safety
- Keyboarding
- Copy & Paste
- How to Email
- How to Print
- Q & A

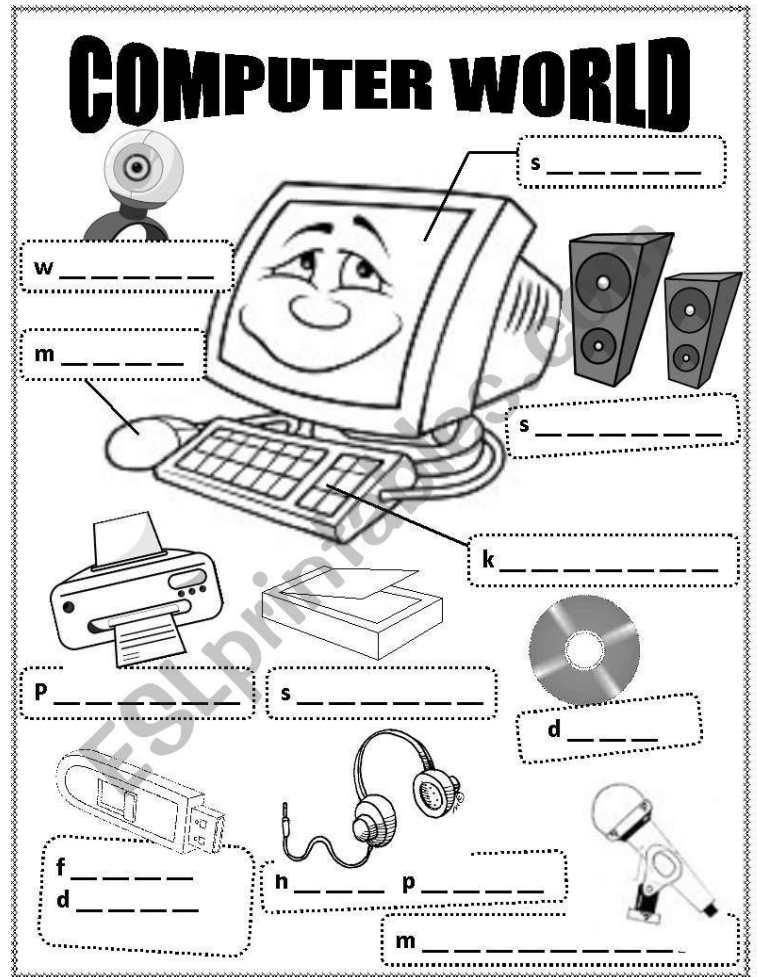

Friendly reminder: They are also available to check out for members to use here at the Senior Center as well.

Join NSC's Legacy Club!

Leave a Legacy and make a donation (monthly or not) of any amount to the NSC Endowment Fund or NSC Operations and once your donations reach \$500, your name will be added to our donor tree. Endowment Fund Donations provide long-term investment income for the Senior Center.



Donor Tree Wall Levels of Giving:

- Tree Leaf: \$500. to \$999.
- Ptarmigan: \$1,000. to \$4,999.
- Crane: \$5,000. to \$9,999.
- Owl: \$10,000. to \$24,999.
- Eagle: \$25,000 +

Thank you to all who donate to the Ninilchik Senior Center!



John Lindeman 3

Jack Christensen 19

Judy Gieger 6

Fred Marshal 21

Kathy Bowen 9

Ron Petty 22

Lynn Harding 9

Linda Pearson 23

Becky Hamilton 10

Dusty Neilson 24

Sharon Cook 15

Debra Erosky 24

Dayton Sibley 15

Dianne Thomas 26

Sharon Reaves 15

Betsey Knox 31

Connie Porter 18



Happy Birthday!

\$5 A Month Club

Thank you to the following who contributed to the club:

David & Judy Clemenson	Bruce Randall
Delmer McCune	Debbie
MacLean	
Nora & Howard Appel	Cathy Perry
Char & Byron Moore	Josie Savoy
John & Janice Nofziger	Jim Beall
Ron Jorgensen	Vi Nordgren

We have a fund to provide items that are not in the budget.

If you would like to join the club, just bring or send a donation of \$5 any time you can.

THANK YOU!!!

Thank You

Vi Nordgren and Kaye Waldsmith
for keeping our silent auction table
full and organized

Char Moore for bringing in Valentines & St. Patrick's Decoration

Dave Nordgren for the trash removal

Steve Vanek for selling split the pot tickets

Don't forget to log all of your time in the volunteer book

Thank you to all of our members and volunteers

Thank you to all the donors

Thank you to our cooks

Ninilchik Senior Center (NSC) Progressive Split the Pot Raffle

Cost: \$1 per ticket. Members may purchase as many tickets as desired each week. Tickets purchased are valid only for that week's drawing. Tickets must be purchased each week until 11am Friday if the member wishes to participate in that week's drawing.

Drawing Time: Every Friday at 12:00 pm

Location: Ninilchik Senior Center 66265 Aspen Ave Ninilchik, AK

Progressive Split the Pot Raffle Rules:

One winner every week.

Winner does not need to be present to win.

Open to NSC members only. Membership must be current.

The Current Raffle will last up to 16 weeks or until someone draws the Eagle. Future raffle duration may change without notice but will be announced at the beginning of each new raffle.



16 cards

(1) Eagle: grand prize winner: 50% of the pot

(1) Owl: 10% of the pot

(14) Ptarmigan: \$5



Name : _____ Date : _____

March Word Search Puzzle

T X Z W U D N N K V S K Z Z D B N G X O Y K I B
F F E L Q I Q E D A R A P T A U T U M N M Q L U
O I W B J H C R A M I K X U F L K S N R S S L R
O R R Z M D U U N Q X X Z W F Q K U F A T I B F
R S E I R A Y K C U L Z E Y O C I R Z H I P B H
E D H V N J L T I X R G E T D B E H L U B H O V
D B F M O U M G N E C B P L I O N T F J K G E J
F N D A O L E D G G C M M F L K X I F B L V Q L
N N I K C I C I G A M R M N H X S H A M R O C K
Z P I N M A R S J T R Y I I U Z R B E R I R O G
C P V Q D N W F X N N O R G N I R P S J K F X A
Y K J G R U D V L Y G N E Q Q L R E K B C Q P P
L B C D J B K R A X G H J P O B Y D V Q L H Z K
N P U E J V P U O K H E U Q T K J R O O D I P C
O E Q I O R H Z M E O V S K G K Z M R L S R O K
X W B Q O V H Q P T R Y F S N U L L B T X S D V
T H F F D D P G M L P U K V D W A U G F V K A I
U N A T T B A V O Y C Z M U F A X Q V A Y E A P
Q X N G Y B H V O S M C Z U B Y A I P J N V Q G
O Q Z M Q Y Q D L I J S E P L D I Z B C O S N V
K K X K O N Q S Z D I J Y H C N X P T B W C N E

Shamrock Rainbow Passover March
Daffodil Autumn Dancing Lion
Spring Clover Magic Julian Lucky
Parade Mars Aries Lamb Kite





Ninilchik Senior Center

Operating Budget and Endowment Fund

Donations to the Operating Budget are used to keep the doors of Center open, while the purpose of the Endowment Fund is to invest for a stable income that will allow the Senior Center to become more self-sufficient.

Your Support is Valuable!

(All gifts are tax deductible to the extent allowed by law)

I am enclosing \$_____ Donation for: ☐ Operating Budget
☐ Endowment Growth

Your Name: _____ Date: _____

Your Address: _____

City: _____ State: _____ Zip: _____

Gift will be a memorial in honor of: _____

You may also make a secure—online donation at: www.ninilchikseniors.org

About The Ninilchik Senior Center

Our Mission

We are dedicated to making life easier, more interesting, and providing assistance to others in need among our members, as well as the surrounding community, in ways which lift the spirit and give a feeling of love to each other. We are dedicated to assisting one another through cooperation, respect, and strength of spirit, so that everyone feels welcome and their contributions valued.

Board of Directors

President: Dick Hawkins
V. President: Viola Nordgren
Secretary: Kaye Waldsmith
Treasurer: Sharon Cook
Trustee: Steve Vanek
Trustee: Cheryl Doyle
Trustee: Lynn Harding

Endowment Trustees

Chair: Kaye Waldsmith
Vice Chair: Steve Vanek
Secretary: Vi Nordgren
Treasurer: John Nofziger
Trustee: David Clemenson

Staff

Executive Director: Julie Otto
Adm. Assist/Bookkeeper:
Tandy Wallace
Assistant: Casey Campbell
Cook: Marti Sue Chapman
Cook/Maintenance: Rick Ferguson
Trans. Driver: Mark Brees
NSC Homemaker: Darla Evans-
Egbert

Join us for lunch!

Lunch is served at 12:00 pm Mon-Fri.
Suggested donation:
\$8 or members, \$12 for non-members
Lunch includes: soup,
salad, entrée and dessert

Events and Activities

Weekly

Mondays:

Quilting/Sewing 1-4 pm

Tuesdays:

Wednesdays:

Bingo (after lunch 1:15 pm)

Thursdays: Game Day 1-4 pm

Fridays:

Knitting 1:30-4:00
Billiards 1-4 pm





So far this Fiscal year the center received **\$84.18** from Fred Meyer through their community rewards program. Thank you to those who participate and make this possible.

If you shop at Fred Meyer, please consider linking your Rewards Card to donate to the center. Fred Meyer will donate money to the center whenever you make purchases; this will not affect the personal rewards associated with your account. Sign up online at: <https://www.fredmeyer.com/topic/community-rewards-4>

The center's Organization Identification Number is **GP013**.

Thank you!!!

The Senior Center is partially funded by these Corporate Sponsors

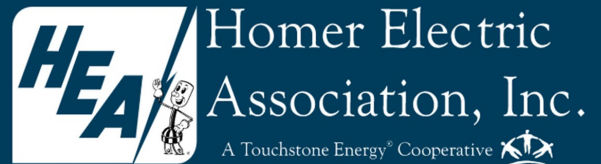





Alaska Food Coalition
Enstar
Fred Meyer/Kroger
HEA
Kenai Peninsula Borough
Meals on Wheels America
Peninsula Bishops Attic
Private Donations
State of Alaska/NTS Grant

March 2024 Menu

Meals will still be available as take-out (\$7 suggested donation, add \$2 for salad).

Please note: menu is subject to change based on product availability. 907-567-3988 Please call in advance to order a meal.

Sunday	Monday	Tuesday	Wednesday	Thursday	Friday	Saturday
Birthdays					1	Information 2
 March					Baked Ham & Swiss Pasta Salad Jell-O	Soup served daily with pick up meals
3	4	5	Bingo @ 1:15 6 Crispy Pork cutlets Dressing Vegetable	7	8	9
John Lindeman 3/3 Judy Gieger 3/6 Kathy Bowen 3/9 Lynn Harding 3/9	Lil' Cheddar Meatloaf Mashed Potatoes Gravy Peas	Spaghetti Bake Vegetable Bread		Baked Chicken Rice Casserole Vegetable	Breakfast Frittata Link Sausage Cubed Potatoes Blueberry Bread Pudding	Suggested Donation \$8.00 Members \$12.00 Guests To-Go Soup \$1.00 per cup
10	11	12	Bingo @ 1:15 13 BBQ Pork w/ Bun Bean Bake Vegetable	14	15	16
Becky Hamilton 3/10 Sharon Cook 3/15 Dayton Sibley 3/15 Sharon Reaves 3/15	Sweet & Sour Meatballs Rice Vegetables	Liver & Onions Potatoes Green Beans		Mushroom Pasta Casserole Vegetable Garlic Bread	Corned Beef & Cabbage Carrots Potatoes	
17	18	19	Bingo @ 1:15 20 Chicken Cordon Bleu Casserole Vegetable Garlic Bread	Board Meeting 21 Asian Pork Medallions Fried Rice Vegetable	22	23
Connie Porter 3/18 Jack Christensen 3/19 Fred Marshall 3/21 Ron Petty 3/22 Linda Pearson 3/23	Roast Beef Potatoes Vegetable	Cheese Enchiladas Beans Mexi-Salad			Croissants w/Chicken Salad Pasta Toss Jell-O	
24	25	26	Bingo @ 1:15 27 Country Pork Ribs Bean Bake Coleslaw Pasta Salad	28	29	30
Dusty Neilson 3/24 Debra Erosky 3/24 Dianne Thomas 3/26	Salisbury Steak Potatoes Gravy Vegetable	Chicken Broccoli Casserole Rice Vegetable		4 Cheese Lasagna Vegetable Garlic Bread	Baked Ham Scalloped Potatoes Vegetable	
31						
Betsey Knox 3/31						