



# Ninilchik Senior Center

PO Box 39422. 66265 Aspen Ave. Ninilchik, AK. 99639 Phone: 567-3988

## Coming Up:

Groundhog Day 2nd

Valentine's Day 14th

President's Day 19th  
(Closed)



## Note From the President of the Board:

Happy February everyone. This is the month that you get to send your sweetie a nice big heart and something sweet, or not. They may not be into candy and such. That doesn't mean you don't think of them on Valentine's Day. The Senior Center staff always decorates for Valentine's Day and it always looks great.

What else is happening in February? Let's see. February 2 is Groundhog's Day! Doesn't seem to make much difference here in Alaska as we all know there will be at least 6 more weeks of winter whether he sees his shadow or not but we'll wait to see what happens for everyone else! There is also President's Day. For you old timers out there (of which I am one) we used to celebrate Washington's Birthday and then Lincoln's birthday only a few days apart. I don't remember both of them being holidays though. Somebody came up with the idea of celebrating all our presidents at one time. That is probably a reasonable solution instead of only celebrating two of them. We don't want all the others to feel slighted you know. I know the Center will be closed on that Monday so take the day off.

There are a few other things I want to mention. First of all our kitchen fund continues its fund raising efforts. We are hoping that this project will be funded by a legislative grant this year. We will find out in June. If it gets funded then the work begins. More on that later.

Another important item to note is that the Board has called a special general membership meeting on March 11 at 12:45 pm to discuss proposed by-law changes. For those that were at the general membership meeting this past summer, you may remember that a by-law review committee was appointed. That committee met several times and presented their proposed changes to the board. The changes were read as required at two board meetings and they now go to the membership for a vote. Additional information will be sent out regarding the proposed changes the first week in February. You do have to be present at the membership meeting to vote, however, if you are unable to make it and have comments, please send them to Julie.

I want to give you a heads up for our first ever gun show at the Senior Center coming along in May. It is a fundraiser for the Center and should be a lot of fun. It is scheduled for May 18 and 19 so mark it on your calendar. Again, more info to come for that event.

Lastly, I want to let you know that Mario Carboni, The Honky Tonk Rebel, will be performing at the Ninilchik Senior Center 4 times this summer. His first show is June 12. Mark it on your calendars.

All for now. Have a safe February all.

~ Richard Hawkins

## **A Note from the Executive Director:**

Cold enough for you?? Seems like we've heard that question a lot over the last month here in Alaska. Fingers crossed that since February has arrived, our cold weather snaps are over and we'll be starting the downhill slope towards spring. The longer days and abundant sunshine do feel nice! February brings with it Valentine's Day. Our fabulous kitchen staff is planning a very special Valentine's lunch – hope you all can join us!

February is also a good time to start thinking about gardening! Although we are a few weeks, even months, away from starting any seedlings, seed catalogs are starting to arrive in the mail! Speaking of gardening, our community garden is going to have a new twist on it this year. The micro-grant we received last year through the Department of Natural Resources was able to be carried over to this year as our new planters didn't arrive in time. New planters? Yes! So far, we have received three but there are several more on order. The planters will go into the community garden for people who may only want to plant a few things and don't want to have to bend down so far to pull weeds. The planters are 8' x 4' and stand two feet off the ground. We will have 8 total that will sit in the garden area for use by our community seniors. They will be filled with gardening soil and ready for your use this summer. We are still planning to add new soil to our existing garden plots also – once all the snow melts of course. Please let us know in the office if you're interested in either signing up for a planter or a full garden plot (8' x 8').



Happy Valentine's day everyone. Remember you're sweetheart on that special day! Do something special for them. Don't have a sweetheart' then do something special for someone else! Here's to special moments of laughter and friendship, sunny days and warmer temperatures!

~ Julie Otto



Happy Valentine's Day to all you Sweethearts out there!! February brings with it Valentine's Day, President's Day, starting to file Income Tax, Leap Year, Super Bowl, and the starting of Baseball Spring Training!! Busy month for sure! So, this month I'm going to take it easy on you. I thought these quotes were appropriate for the times.

"Most folks are as happy as they make up their minds to be."

Abraham Lincoln

"Human kindness has never weakened the stamina or softened the fiber of a free people. A nation does not have to be cruel to be tough."

Franklin D. Roosevelt

"Friendship is the only cement that will ever hold the world together."

Woodrow Wilson

Who Am I?

A memorial has been built in my honor

Although not a soldier, I know all about war

Most people carry a picture of me

Many of my words are well remembered

I was President of the United States

A state capital is named after me

I am American

I am a political figure

I am skilled with an axe

I am a 19th century figure

Brain Power

What is the only U.S. state that borders two other states that start with the same letter as that state?

Here's to sunshine and warmer weather and as always swing for the fence!

Cheryl

Answers: Abraham Lincoln and Illinois (Iowa and Indiana)

# KENAI PENINSULA FAMILY CAREGIVER SUPPORT PROGRAM

Short Presentation followed by a Q & A session.

Monday, February 26th @ 11:45 AM

Dani Kebschull

Email: [kpfcsp@nikiskiseniorcenter.org](mailto:kpfcsp@nikiskiseniorcenter.org)

Provide services and support for unpaid caregivers of loved one's 60+ years old, or caregivers of anyone with Alzheimer's Disease or Related Disorder (ADRD).

Providing services throughout the entire Kenai Peninsula.





# **Make Cards With Kimberly!**

Tuesday February 6th @  
1:00 come on in and make  
some beautiful homemade  
cards!



*From Ninilchik*

*Senior Center Staff*



*Julie Otto*

*Tandy Wallace*



*Casey Campbell*



*Mark Brees*



*Marti-Sue Chapman*



*Darla Evans-Egbert*



*Rick Ferguson*



# Valentine Trivia

Put an "x" beside the answer you think is right!

1. Who is known as the "Mother of the Valentine"?

- ☐ a. Kate Greenway
- ☐ b. Esther A. Howland
- ☐ c. Aphrodite
- ☐ d. Joyce C. Hall



2. It is said that St. Valentine fell in love with whom?

- ☐ a. His jailor's daughter
- ☐ b. His neighbor's daughter
- ☐ c. A nun in his parish
- ☐ d. His teacher

3. In Greek mythology, Cupid was called what?

- ☐ a. Artemis
- ☐ b. Amor
- ☐ c. Kama
- ☐ d. Eros

4. Valentine's Day replaced which pagan holiday?

- ☐ a. Saturnalia
- ☐ b. Thesmophoria
- ☐ c. Lupercalia
- ☐ d. Brumalia

5. Who first brought the Valentine to America?

- ☐ a. The Puritans
- ☐ b. The Quakers
- ☐ c. The French
- ☐ d. The Pilgrims

6. During the Roaring 20s, what were Valentines often shaped like?

- ☐ a. Violets
- ☐ b. Music notes
- ☐ c. Apples
- ☐ d. Tomatoes



7. Candy was first given as a Valentine's Day gift in the 17th century and was inspired by which Shakespearean character?

- ☐ a. Juliet
- ☐ b. Julius Caesar
- ☐ c. Hamlet
- ☐ d. Othello

8. How many Valentine cards are exchanged each year?

- ☐ a. 8 million
- ☐ b. 15 million
- ☐ c. 1 billion
- ☐ d. 2 billion

9. Who created the first heart shaped box of Valentine chocolates?

- ☐ a. Richard Cadbury
- ☐ b. Rodolphe Lindt
- ☐ c. Coenraad VanHouten
- ☐ d. Jean Tobler



10. One out of every five Valentines is received by whom?

- ☐ a. Teachers
- ☐ b. School friends
- ☐ c. Parents
- ☐ d. Employers

11. Traditionally, if a woman saw a robin fly overhead on Valentine's Day it was said she would marry:

- ☐ a. A millionaire
- ☐ b. A poor man
- ☐ c. A prince
- ☐ d. A sailor

12. After cards, what is the most popular Valentine's Day gift?

- ☐ a. flowers
- ☐ b. candy
- ☐ c. romantic dinner
- ☐ d. Jewelry

13. What does "Valentine" mean?

- ☐ a. Love
- ☐ b. Romance
- ☐ c. Strong
- ☐ d. Betrothal



14. What was the first company to manufacture valentines?

- ☐ a. Norcross
- ☐ b. Hallmark
- ☐ c. Raphael Tuck and Sons
- ☐ d. Greenway

15. What is the most popular Valentine's Day symbol?

- ☐ a. Heart
- ☐ b. Rose
- ☐ c. Cupid
- ☐ d. Love knot

Be My Valentine





*1985 Teddy's Toys & Co., All Rights Reserved.*

*All Questions and answers are from 1985 Teddy's Toys & Co., All Rights Reserved.*

1. What river flows through Fairbanks, Alaska?
2. Name the organization that was created in the mid 1960's to represent the native groups within the state and was instrumental in settling the Land Claims issue?
3. How wide is the pipe on the Trans Alaska pipeline? (24" , 36" , 48")
4. Name the bear that is smokey– blue or blue-grey found in the Yakutat are.
5. Name the city that got its name from being a protected water area where ships could anchor safely.
6. In navigational terms, what is a concentration of sand in a channel or stream that interferes with navigation?
7. True or False: When the Russians first tried to settle in Sitka the Tlingit Indians tried to keep them out and battled with them.
8. What is a "hoochie"?

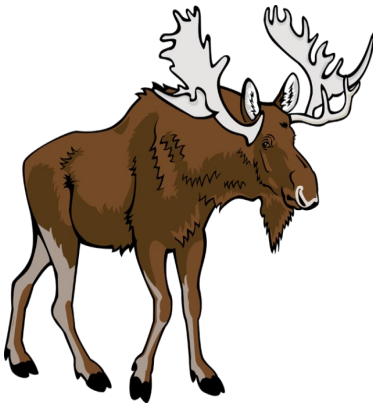

7.True  
8.A Fishing Lure

2.Alaska Federation of Na-

1.Chena River  
tves  
3.48 Inches  
4.Glacier Bear  
5.Anchorage  
6.Bar



Please see the office to sign up for computer lessons!

Including:

- Basic computer navigation skills
- How to search the internet
- Video Chat with family
- Internet Safety
- Keyboarding
- Copy & Paste
- How to Email
- How to Print
- Q & A

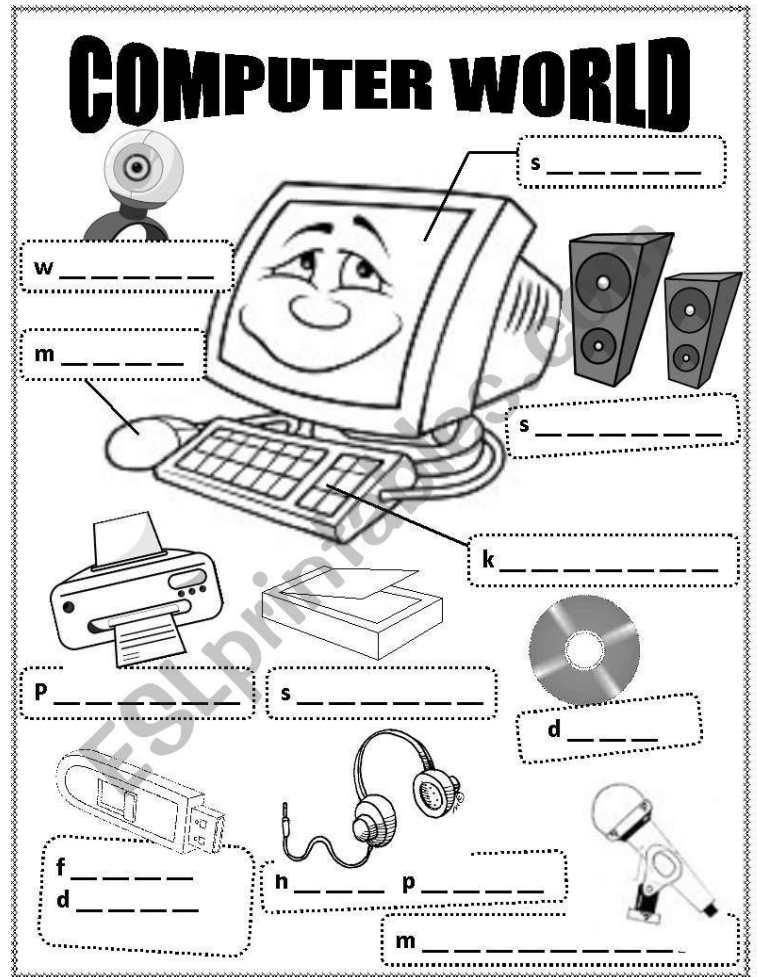

Friendly reminder: They are also available to check out for members to use here at the Senior Center as well.

# Valentine's Trivia

Put an "x" beside the answer you think is right!

1. Who is known as the "Mother of the Valentine"?

- ☐ a. Kate Greenway
- ☒ b. Esther A. Howland
- ☐ c. Aphrodite
- ☐ d. Joyce C. Hall

2. It is said that St. Valentine fell in love with whom?

- ☒ a. His jailor's daughter
- ☐ b. His neighbor's daughter
- ☐ c. A nun in his parish
- ☐ d. His teacher

3. In Greek mythology, Cupid was called what?

- ☐ a. Artemis
- ☐ b. Amor
- ☐ c. Kama
- ☒ d. Eros

4. Valentine's Day replaced which pagan holiday?

- ☐ a. Saturnalia
- ☐ b. Thesmophoria
- ☒ c. Lupercalia
- ☐ d. Brumalia

5. Who first brought the Valentine to America?

- ☐ a. The Puritans
- ☒ b. The Quakers
- ☐ c. The French
- ☐ d. The Pilgrims

6. During the Roaring 20s, what were Valentines often shaped like?

- ☐ a. Violets
- ☐ b. Music notes
- ☐ c. Apples
- ☒ d. Tomatoes

7. Candy was first given as a Valentine's Day gift in the 17th century and was inspired by which Shakespearean character?

- ☐ a. Juliet
- ☐ b. Julius Caesar
- ☒ c. Hamlet
- ☐ d. Othello

8. How many Valentine cards are exchanged each year?

- ☐ a. 8 million
- ☐ b. 15 million
- ☒ c. 1 billion
- ☐ d. 2 billion

9. Who created the first heart shaped box of Valentine chocolates?

- ☒ a. Richard Cadbury
- ☐ b. Rodolphe Lindt
- ☐ c. Coenraad VanHouten
- ☐ d. Jean Tobler

10. One out of every five Valentines is received by whom?

- ☒ a. Teachers
- ☐ b. School friends
- ☐ c. Parents
- ☐ d. Employers

11. Traditionally, if a woman saw a robin fly overhead on Valentine's Day it was said she would marry:

- ☐ a. A millionaire
- ☐ b. A poor man
- ☐ c. A prince
- ☒ d. A sailor

12. After cards, what is the most popular Valentine's Day gift?

- ☐ a. flowers
- ☒ b. candy
- ☐ c. romantic dinner
- ☐ d. Jewelry

13. What does "Valentine" mean?

- ☐ a. Love
- ☒ b. Romance
- ☐ c. Strong
- ☐ d. Betrothal

14. What was the first company to manufacture valentines?

- ☒ a. Norcross
- ☐ b. Hallmark
- ☐ c. Raphael Tuck and Sons
- ☐ d. Greenway

15. What is the most popular Valentine's Day symbol?

- ☐ a. Heart
- ☐ b. Rose
- ☒ c. Cupid
- ☐ d. Love knot

Be My Valentine

# Join NSC's Legacy Club!

Leave a Legacy and make a donation (monthly or not) of any amount to the NSC Endowment Fund or NSC Operations and once your donations reach \$500, your name will be added to our donor tree. Endowment Fund Donations provide long-term investment income for the Senior Center.



## Donor Tree Wall Levels of Giving:

- Tree Leaf: \$500. to \$999.
- Ptarmigan: \$1,000. to \$4,999.
- Crane: \$5,000. to \$9,999.
- Owl: \$10,000. to \$24,999.
- Eagle: \$25,000 +

Thank you to all who donate to the Ninilchik Senior Center!



Bill Hamilton 1	Jonelle Hawkins 13
Sherry Pinckley 4	Debbie MacLean 14
Moondog Gott 4	Brent Johnson 18
Robert Hamilton 5	Shoney Parker 18
Dave Smith 5	Ellen Smith 23
Bob Wasser 8	Mark Brees 23
Sharon Griggs 9	Barbara Sibley 24
Willard Bauman 12	Darwin Waldsmith 27
Joseph Gardner III 13	Walter Welz 29



### **\$5 A Month Club**

Thank you to the following who contributed to the club:

David & Judy Clemenson	Bruce Randall
Delmer McCune	Debbie MacLean
Nora & Howard Appel	Cathy Perry
Char & Byron Moore	Josie Savoy
John & Janice Nofziger	Jim Beall
Ron Jorgensen	Vi Nordgren

We have a fund to provide items that are not in the budget.

If you would like to join the club, just bring or send a donation of \$5 any time you can.

**THANK YOU!!!**

### **Thank You**

Vi Nordgren and Kaye Waldsmith for keeping our silent auction table full and organized

JoJo Seitz for sorting stuff for the gazebo

Dave Nordgren for the trash removal

Steve Vanek for selling split the pot tickets

Don't forget to log all of your time in the volunteer book

Thank you to all of our members and volunteers

Thank you to all the donors

Thank you to our cooks



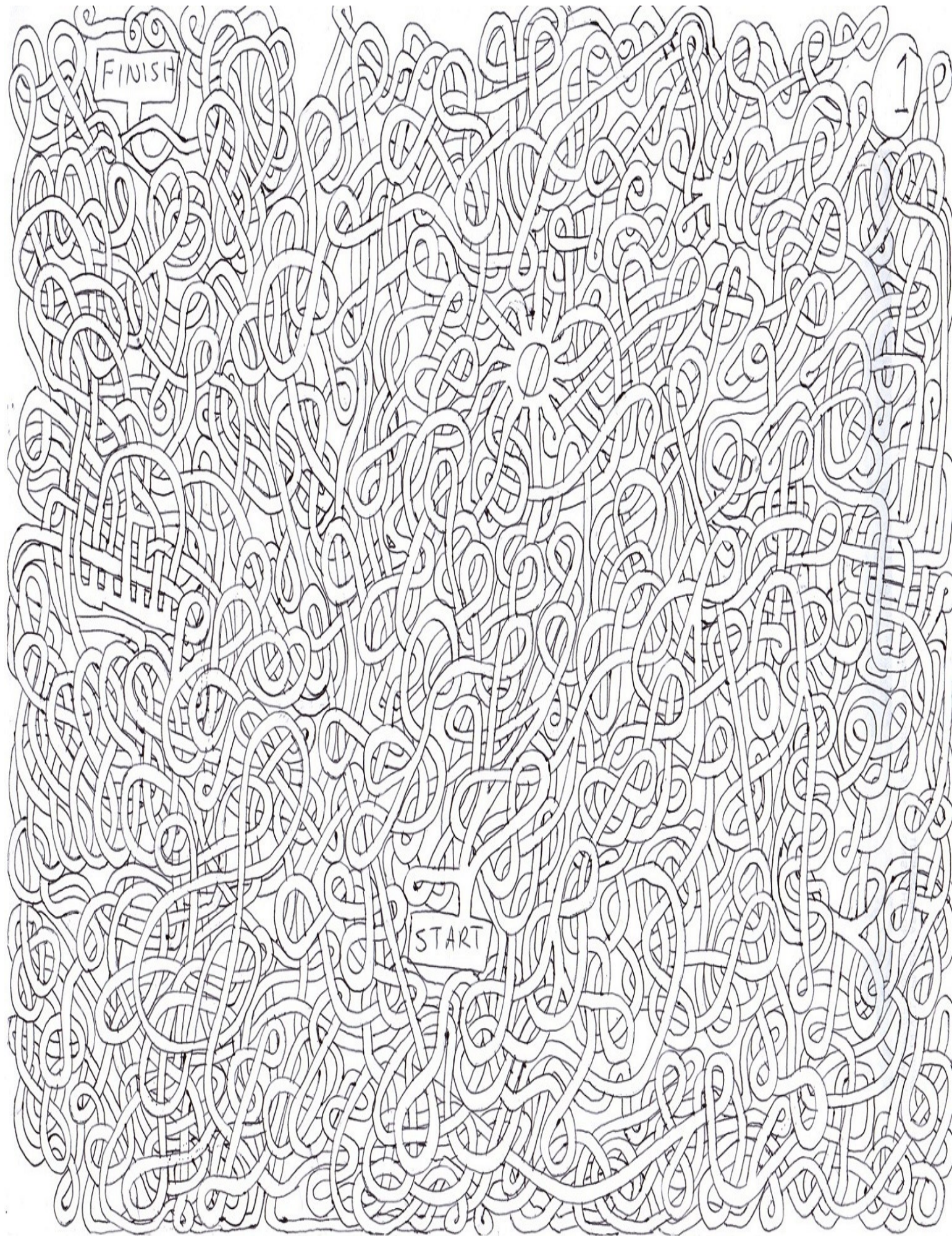



# Ninilchik Senior Center (NSC) Progressive Split the Pot Raffle

Cost: \$1 per ticket. Members may purchase as many tickets as desired each week. Tickets purchased are valid only for that week's drawing. Tickets must be purchased each week until 11am Friday if the member wishes to participate in that week's drawing.

Drawing Time: Every Friday at 12:00 pm

Location: Ninilchik Senior Center 66265 Aspen Ave Ninilchik, AK

## Progressive Split the Pot Raffle Rules:

One winner every week.

Winner does not need to be present to win.

Open to NSC members only. Membership must be current.

The Current Raffle will last up to 16 weeks or until someone draws the Eagle. Future raffle duration may change without notice but will be announced at the beginning of each new raffle.



## 16 cards

(1) Eagle: grand prize winner: 50% of the pot

(1) Owl: 10% of the pot

(14) Ptarmigan: \$5







## Ninilchik Senior Center

### Operating Budget and Endowment Fund

Donations to the Operating Budget are used to keep the doors of Center open, while the purpose of the Endowment Fund is to invest for a stable income that will allow the Senior Center to become more self-sufficient.

#### **Your Support is Valuable!**

(All gifts are tax deductible to the extent allowed by law)

I am enclosing \$\_\_\_\_\_ Donation for: ☐ Operating Budget  
☐ Endowment Growth

Your Name: \_\_\_\_\_ Date: \_\_\_\_\_

Your Address: \_\_\_\_\_

City: \_\_\_\_\_ State: \_\_\_\_\_ Zip: \_\_\_\_\_

Gift will be a memorial in honor of: \_\_\_\_\_

You may also make a secure—online donation at: [www.ninilchikseniors.org](http://www.ninilchikseniors.org)

# About The Ninilchik Senior Center

## Our Mission

We are dedicated to making life easier, more interesting, and providing assistance to others in need among our members, as well as the surrounding community, in ways which lift the spirit and give a feeling of love to each other. We are dedicated to assisting one another through cooperation, respect, and strength of spirit, so that everyone feels welcome and their contributions valued.

## Board of Directors

President: Dick Hawkins  
V. President: Viola Nordgren  
Secretary: Kaye Waldsmith  
Treasurer: Sharon Cook  
Trustee: Steve Vanek  
Trustee: Cheryl Doyle  
Trustee: Lynn Harding

## Endowment Trustees

Chair: Kaye Waldsmith  
Vice Chair: Steve Vanek  
Secretary: Vi Nordgren  
Treasurer: John Nofziger  
Trustee: David Clemenson

## Staff

Executive Director: Julie Otto  
Adm. Assist/Bookkeeper:  
Tandy Wallace  
Assistant: Casey Campbell  
Cook: Marti Sue Chapman  
Cook/Maintenance: Rick Ferguson  
Trans. Driver: Mark Brees  
NSC Homemaker: Darla Evans-  
Egbert

## Join us for lunch!

Lunch is served at 12:00 pm Mon-Fri.  
Suggested donation:  
\$8 or members, \$12 for non-members  
Lunch includes: soup,  
salad, entrée and dessert

## Events and Activities

### Weekly

**Mondays:**  
Quilting/Sewing 1-4 pm

**Tuesdays:**

**Wednesdays:**  
Bingo (after lunch 1:15 pm)

**Thursdays:** Game Day 1-4 pm

**Fridays:**  
Knitting 1:30-4:00  
Billiards 1-4 pm

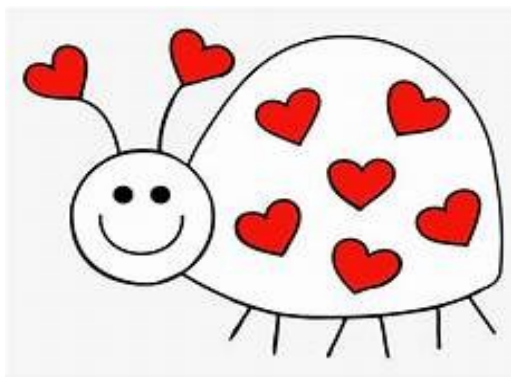

## Valentine's Day Word Search

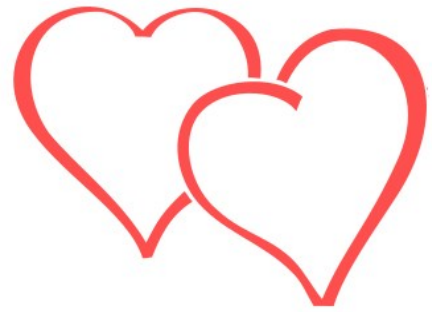

Circle each word in the Valentine's Day word search puzzle below.

X P I N K N H S N U O T G N L T  
E O I G Y T E E Y V N C C U I C  
G E N I T N E L A V U E O E H G  
N M F F O N B T O R D R R O F K  
E Y N T P M S E C K T X C R N S  
V E N S P N M U O E M O E S M R  
O O X K S N P W C O L I R O S E  
L A E A B I D N U A D C S N E W  
I C A R D T K U T K N Y T E F O  
E N E U Z A I E H U N D Z H U L  
M V B L E M N O L G M V Y O N F  
K S W E E T H E A R T A F S I R

1: HEART

2. CUPID

3. CARD

4. VALENTINE

5. LOVE

6: POEM

7. CHOCOLATE

8. CANDY

9. KISS

10. ROSE

11: FLOWERS

12. PINK

13. SWEETHEART

14. GIFT

15. HUG





So far this Fiscal year the center received **\$84.18** from Fred Meyer through their community rewards program. Thank you to those who participate and make this possible.

If you shop at Fred Meyer, please consider linking your Rewards Card to donate to the center. Fred Meyer will donate money to the center whenever you make purchases; this will not affect the personal rewards associated with your account. Sign up online at: <https://www.fredmeyer.com/topic/community-rewards-4>

The center's Organization Identification Number is **GP013**.

**Thank you!!!**

The Senior Center is partially funded by these Corporate Sponsors

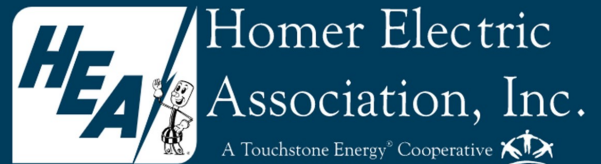

Alaska Food Coalition  
Enstar  
Fred Meyer/Kroger  
HEA  
Kenai Peninsula Borough  
Meals on Wheels America  
Peninsula Bishops Attic  
Private Donations  
State of Alaska/NTS Grant

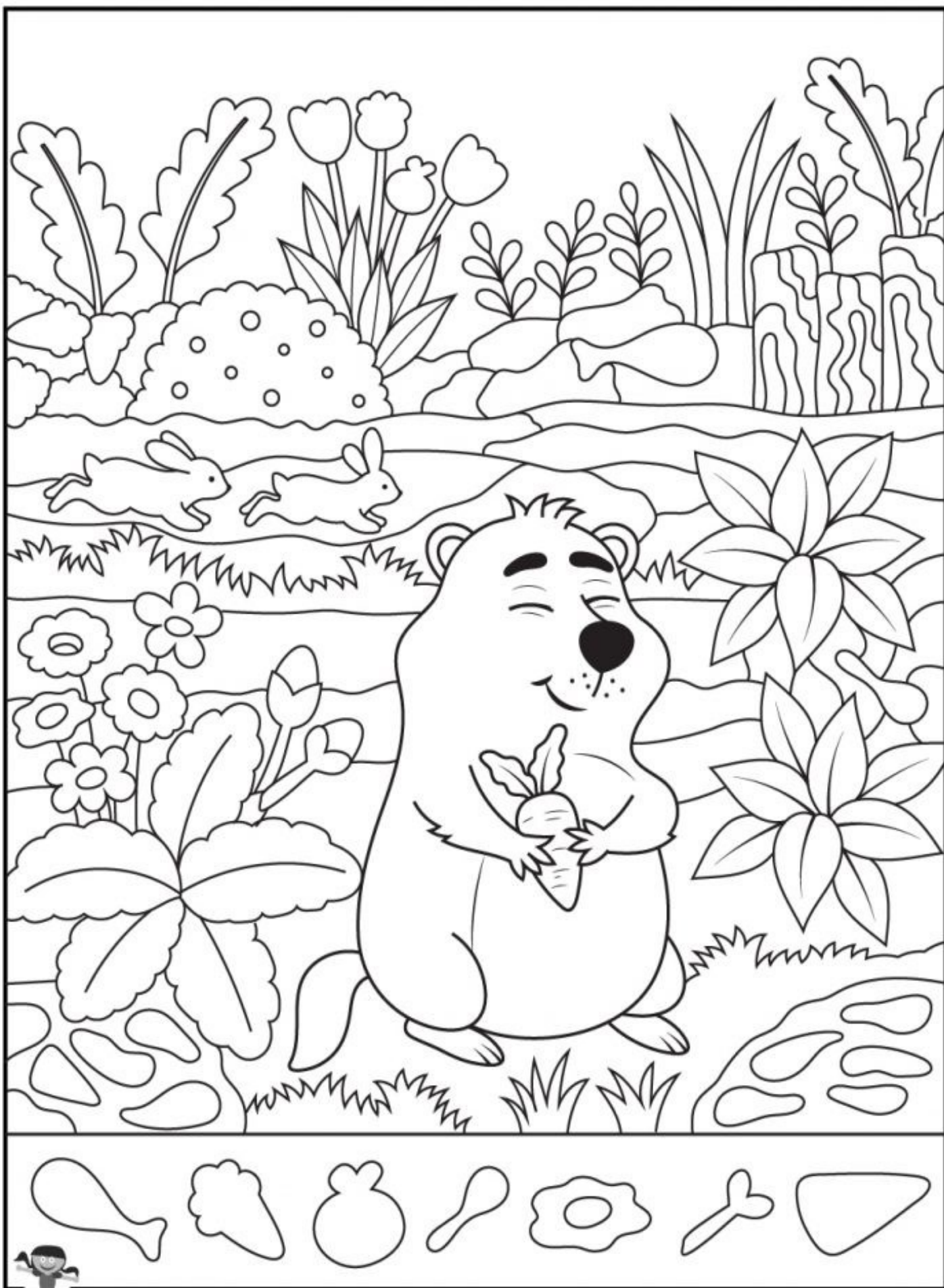





# February 2024 Menu

Meals will still be available as take-out (\$7 suggested donation, add \$2 for salad).

Please note: menu is subject to change based on product availability. 907-567-3988 Please call in advance to order a meal.

Sunday	Monday	Tuesday	Wednesday	Thursday	Friday	Saturday
<b>Birthdays</b>				1	2	<b>Information</b> 3
Bill Hamilton 2/1				Salisbury Steak Mashed Potatoes Vegetable	Ham & Swiss on a bun French Fries Macaroni Salad 	Soup served daily with pick up meals
4	5	6	<i>Bingo @ 1:15</i> 7	8	9	10
Sherry Pinckley 2/4 Moondog Gott 2/4 Robert Hamilton 2/5 Dave Smith 2/5 Bob Wasser 2/8 Sharon Griggs 2/9	Baked Chicken Potatoes Gravy Vegetable	Sweet & Sour Meatballs Ancient Grains Vegetable	Mushroom Pasta Bake Vegetables Garlic Bread	Cranberry Pork Loin Dressing Vegetable	Croissant w/Chicken Salad Pasta Toss Jell-O	Suggested Donation \$8.00 Members \$12.00 Guests To-Go Soup \$1.00 per cup
11	12	13	<i>Bingo @ 1:15</i> 14	<i>Board Meeting</i> 15	16	17
Willard Bauman 2/12 Joseph Gardner III 2/13 Jonelle Hawkins 2/13 Debbie MacLean 2/14	Monterey Chicken Breasts Rice Vegetable	BBQ Pork w/Bun Corn Bean Bake Coleslaw	Roast Beef Au Jus Potato Casserole Shrimp Salad Broccoli	Almond Chicken Breast Ancient Grains Stir Fry Vegetables	4 Cheese Lasagna Vegetable Garlic Bread	
18	19	20	<i>Bingo @ 1:15</i> 21	22	23	24
Brent Johnson 2/18 Shoney Parker 2/18 Ellen Smith 2/23 Mark Brees 2/23 Barbara Sibley 2/24	<b>Center Closed For President's Day</b>	Baked Chicken Rice Vegetables	Spaghetti Bake Vegetable Bread	Country Pork Ribs Coleslaw Scalloped Potatoes Corn	Breakfast Frittata Cubed Potatoes Blueberry Bread Pudding Link Sausage	
25	26	27	<i>Bingo @ 1:15</i> 28	29		
Darwin Waldsmith 2/27 Walter Welz 2/29	Glazed Pork Tenderloin Potatoes Gravy Vegetable	Cheese Enchiladas Refried Beans Mexi Salad	Smoked Sausage Potatoes Green Beans	Hawaiian Chicken Rice Vegetable Eggrolls		